



Herd-Kessel

State: 29.06.2016



BRUNNER[®]
made in germany

Dimension sheet | **Herd-Kessel**

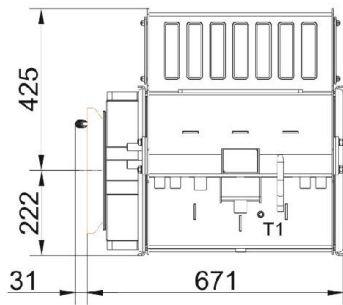
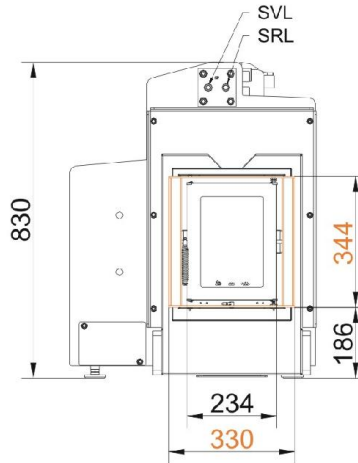
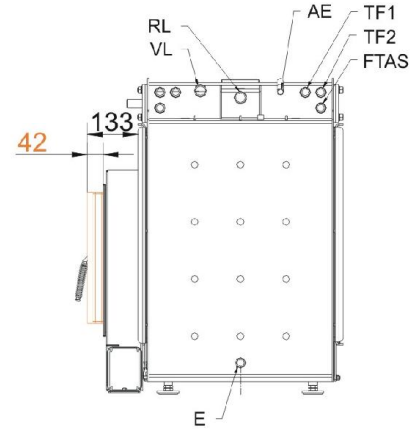

- VL supply 1"
- RL return boiler 1"
- E drain 1/2"
- SVL supply cooling pipe outlet
- SRL return cooling pipe outlet
- FTAS socket for thermometer cooling
- TF1 socket 1/2" for thermometer
- TF2 socket 1/2" for thermometer
- AE socket 3/8" for vent

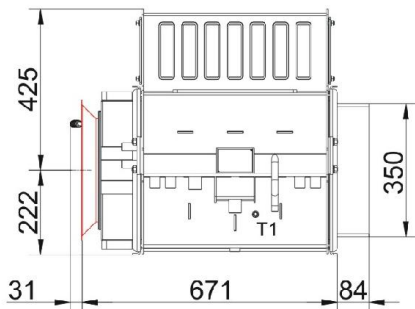
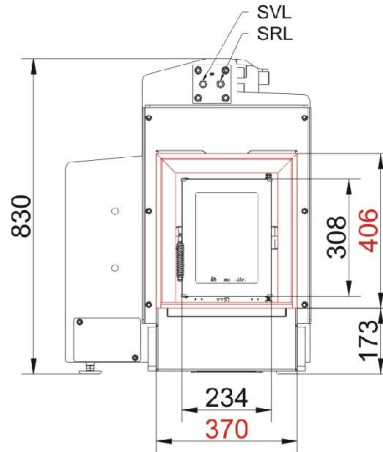
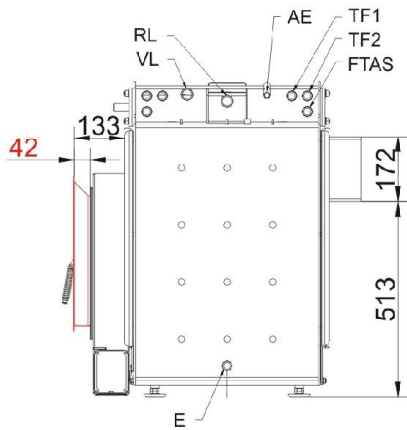

- VL supply 1"
- RL return boiler 1"
- E drain 1/2"
- SVL supply cooling pipe outlet
- SRL return cooling pipe outlet
- FTAS socket for thermometer cooling
- TF1 socket 1/2" for thermometer
- TF2 socket 1/2" for thermometer
- AE socket 3/8" for vent

... with additional charge for DHT fire door

Dimension sheet | **Herd-Kessel**

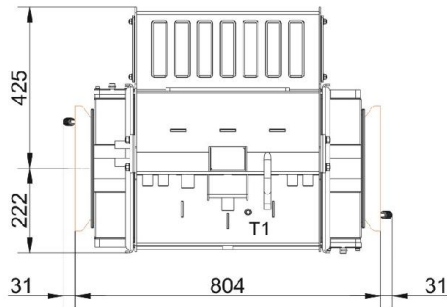
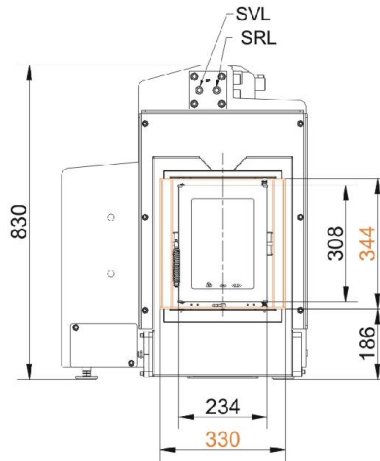
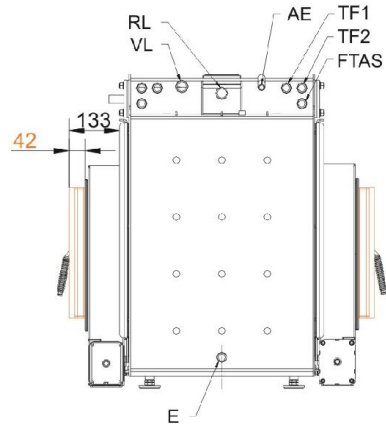

- VL supply 1"
- RL return boiler 1"
- E drain 1/2"
- SVL supply cooling pipe outlet
- SRL return cooling pipe outlet
- FTAS socket for thermometer cooling
- TF1 socket 1/2" for thermometer
- TF2 socket 1/2" for thermometer
- AE socket 3/8" for vent

... tunnel

Planning and installation

Herd-Kessel

Tested according to
Values for mode of operation

EN 12815
rated load

EN 12815
practical avg.

Data for functional demonstration

Rated heat power	kW	13	-
Rated heat power	kg/h	3,8	6
Combustion performance	kW	16,5	20
Flue gas mass flow	g/s	18	22
Outlet temperature (before heating surface)	°C	410	505
Flue gas temperature after			
attached steel smoke hood	°C	-	-
adjoining cast iron radiator (GNF10)	°C	-	-
accumulation rings (MAS) ¹⁾	°C	-	-
adjoining ceramic accumulator ²⁾	°C	-	-
accumulation stones (MSS) ²⁾	°C	-	-
Boiler	°C	200	-
Necessary supply pressure	Pa	12	15
Combustion air consumption	m ³ /h	50	80
Combustion air connection Ø	mm	125	125

Heat distribution

Insert / heating surface	%	- / 44 - 27	- / 44 - 27
Glass (single / double)	%	- / 8	- / 8
Boiler	%	48 - 65	48 - 65

Vent cross-sections ⁴⁾

Supply air	cm ²	- / - / -	- / - / -
Warm air	cm ²	- / - / -	- / - / -

Min. distances of fireplace

Distance to insulation layer	cm	6	6
Distance to floor	cm	15	15

Heat insulation without / with ³⁾ air gratings

Wall	cm	Fachregel	Fachregel
Floor	cm	Fachregel	Fachregel
Ceiling	cm	-	-
Brick lining of protected walls	cm	10	10

Water boiler data

Max. operating pressure	bar	3	3
Max. flow temperature	°C	100	100
Water volume	litres	42	42
Connections flow / return	inch	1	1

Weight

Fireplace + burning chamber	kg	172 + 52
-----------------------------	----	----------

meets requirement limit values for

Germany / Austria / Switzerland / Norway

1.BImSchV (Stufe 2) / - / LRV / -

1) Throttle flap recommended

2) Approximate value. Determination according to design characteristics for adjacent storage mass or proof of function provided

3) Values with air gratings, stove casing is heat conducting

4) for firebox / flue gas pipe / metallic reheating surface

Ulrich Brunner GmbH
Zellhuber Ring 17 -18
D-84307 Eggenfelden
Telefon: +49 / (0)87 21 / 7 71-0
Telefax: +49 / (0)87 21 / 7 71-100
info@brunner.eu | www.brunner.eu

BRUNNER products are offered and sold only by qualified dealers and service centres.
Subject to technical and assortment changes. Errors excepted. (06/16)