

BRUNNER SYSTEM MASONRY HEATERS



BSG 01 mit MSS für GOT 51/67-ZL DT mit GOF 66x42

State: 12.10.2016



BRUNNER[®]
made in germany

Dimension sheet | **BSG 01 mit MSS**

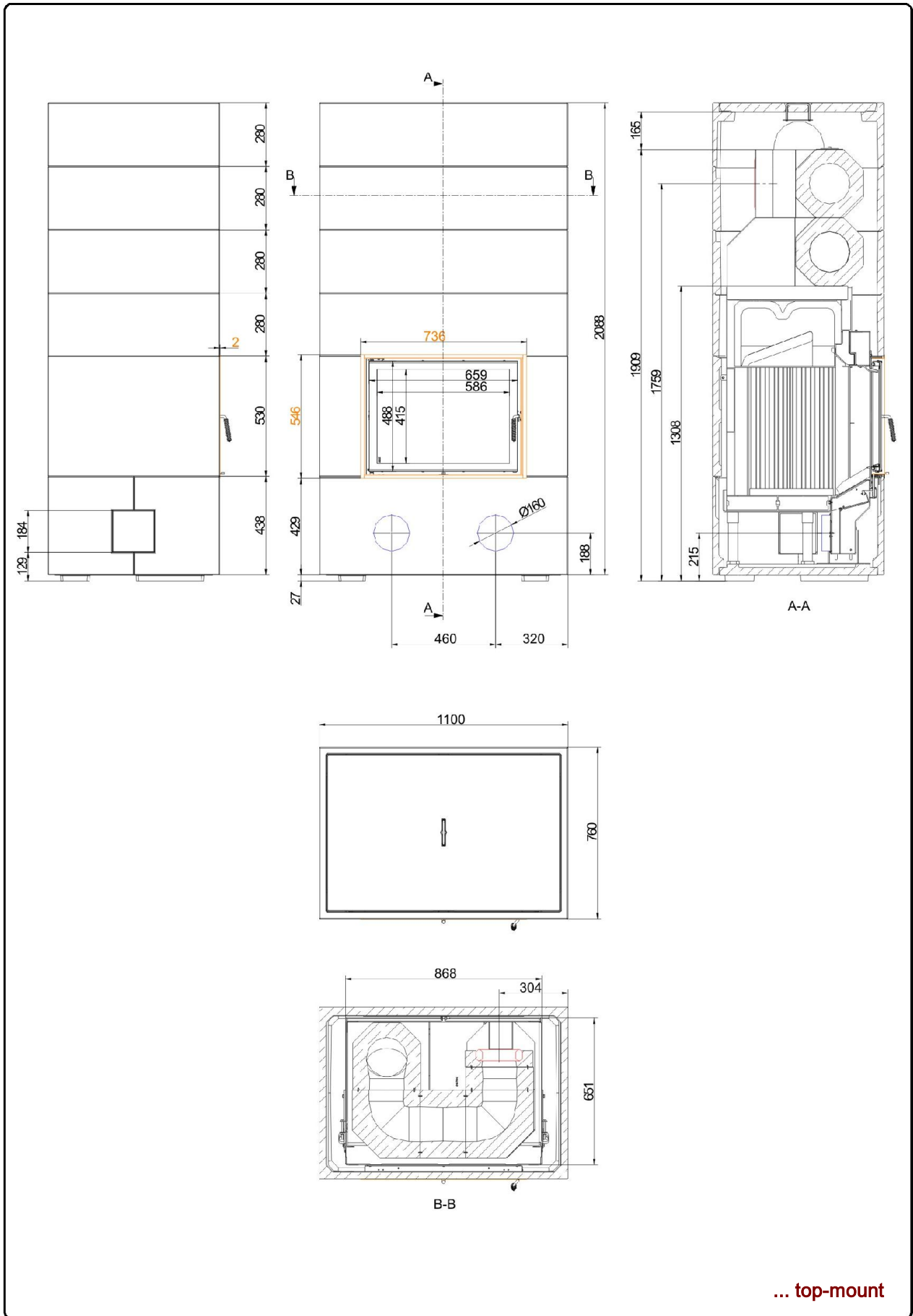

... top-mount

We suggest for CAD planing Palette CAD. Permanent updated drawings: www.brunner.de
 Frames / front versions are marked colored.

Dimension sheet | **BSG 01 mit MSS**

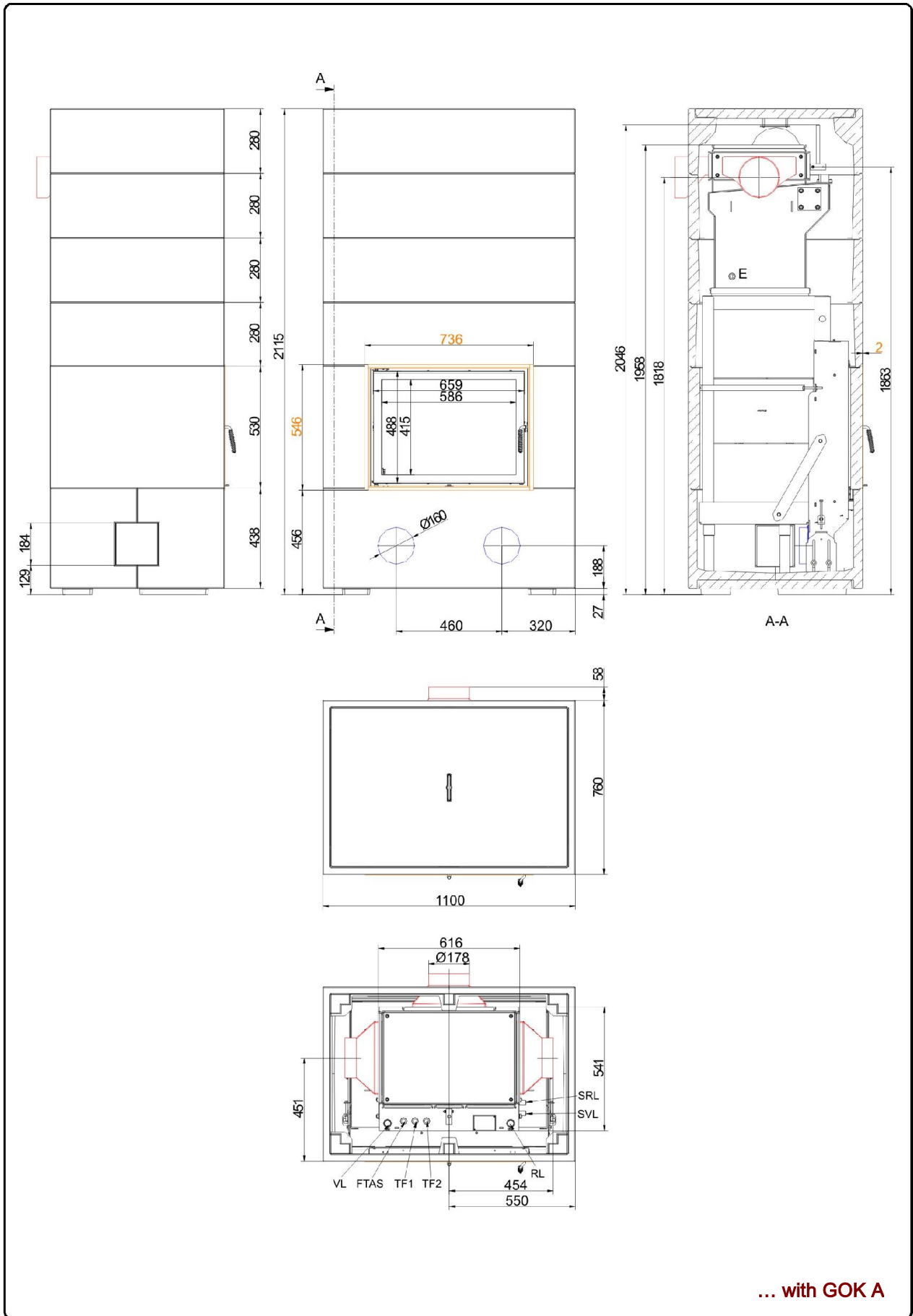

We suggest for CAD planing Palette CAD. Permanent updated drawings: www.brunner.de
 Frames / front versions are marked colored.

Planning and installation

BSG 01 mit MSS

Masonry heater tested according to		EN 15250	EN 15250	EN 15250
Data for functional demonstration		top-mount MSS	adjacent MSS	GOK A
Rated heat power	kW	-	-	7,2
Total fuel load	kg	12	17	17
Fuel amount for 1st / 2nd combustion cycle	kg	8 + 4	9 + 8	9 + 8
Combustion duration	h	2	2	2
Used quantity of wood	kg/h	7,9	8,3	8,3
Heat storage duration ¹⁾	h	12	12	12
System power ³⁾	kW	2,2	2,8	1,4
Combustion performance	kW	31,6	33,2	33,2
Flue gas mass flow	g/s	24,4	25,5	25,5
Outlet temperature	°C	550	550	550
Flue gas temperature	°C	195	190	180
Necessary supply pressure	Pa	12	12	12
Combustion air consumption	m ³ /h	71	74	74
Combustion air connection Ø	mm	160	160	160
Heat distribution				
Insert / heating surface	%	30 / 50	30 / 50	30 / -
Glass (single / double)	%	- / 20	- / 20	- / 20
Boiler	%	-	-	50
Minimum distance				
to adjacent wall ²⁾	cm	5	5	5
to the ground	cm	0	0	0
from top of fireplace to the ceiling	cm	30	30	30
Thermal insulation according to TROL				
Water boiler data				
Max. operating pressure	bar	-	-	3
Max. flow temperature	°C	-	-	100
Water volume	liters	-	-	63
Connections flow / return	inch	-	-	1
Weight				
Combustion chamber + storage / GOK A	kg	520 + 298	520 + 332	520 + 145
Cladding	kg	443	734	443
Total weight	kg	1261	1586	1108
meets requirement limit values for:				
Germany / Austria / Switzerland / Norway		1.BImSchV (Stufe 2) / 15a BVG (2015) / LRV / -		

- 1) Time from ignition until reaching 25% of maximal surface temperature against room temperature
- 2) Next to a wall that has to be protected a brick lining or a substitute insulating material is required.
- 3) average heating power of the system (heat storage duration with load of wood 1st/2nd combustion cycle)

Ulrich Brunner GmbH
 Zellhuber Ring 17 -18
 D-84307 Eggenfelden
 Telefon: +49 / (0)87 21 / 7 71-0
 Telefax: +49 / (0)87 21 / 7 71-100
 info@brunner.eu | www.brunner.eu

